

Nintendo Switch 2

Important Information

Nintendo may change product specifications and update this information from time to time. The latest version of this document is available at <https://www.nintendo.com/eu/docs> (This service may not be available in some countries.)

Using this Console



TV mode

1

Nintendo Switch 2 dock



2



Tabletop mode

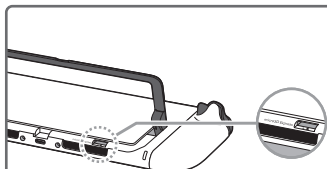
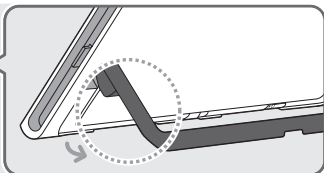

Inserting a microSD Express memory card

Health and Safety Information

Please read and observe the health and safety information. Failure to do so could result in injury or damage. Adults should supervise the use of this product by children. Retain this information for future reference.

⚠ WARNING – Seizures

- Some people (about 1 in 4000) may have seizures or blackouts triggered by light flashes or patterns, and this may occur while they are watching TV or playing video games, even if they have never had a seizure before. Anyone who has ever experienced seizures, loss of awareness or any other symptom linked to an epileptic condition should consult a doctor before playing video games.
- Stop playing and consult a doctor if you have any unusual symptoms, such as: convulsions, eye or muscle twitching, loss of awareness, altered vision, involuntary movements, or disorientation.
- To reduce the likelihood of a seizure when playing video games:
 - Do not play if you are tired or need sleep.
 - Play in a well-lit room.
 - Take a break of 10 to 15 minutes at least once an hour.

⚠ WARNING – Eye Strain, Motion Sickness and Repetitive Motion Injuries

- Avoid excessively long play sessions.
- Take a break of 10 to 15 minutes at least once an hour, even if you don't think you need it.
- Stop playing if you experience any of these symptoms:
 - If your eyes become tired or sore while playing, or if you feel dizzy, nauseated or tired;
 - If your hands, wrists, or arms become tired or sore while playing, or if you feel tingling, numbness, burning or stiffness or other discomfort.

If any of these symptoms persist, consult a doctor.

⚠ WARNING – Pregnancy and Medical Conditions

If you are pregnant or have any medical condition that may be aggravated by physical activity, consult a doctor before playing games that may require physical activity.

⚠ WARNING – Batteries

- Stop using if a battery is leaking. If battery fluid comes into contact with your eyes, immediately rinse your eyes with plenty of water and consult a doctor. If any fluid leaks on your hands, wash them thoroughly with water. Carefully wipe the fluid from the exterior of the device with a cloth.
- The console and Joy-Con™ 2 controllers each contain a rechargeable lithium-ion battery. Do not replace the batteries yourself. The batteries must be removed and replaced by a qualified professional. Please contact Nintendo Customer Support for more information.

⚠ WARNING – Electrical Safety

- Use the Nintendo Switch 2 AC adapter (NGN-01) or a compatible AC adapter to charge the console. For power requirements, see the section "Power Requirements and EU Common Charger Information".
- Observe the following precautions when using the Nintendo Switch 2 AC adapter (NGN-01):
 - Connect the AC adapter to the correct voltage (AC 100 – 240V).
 - Do not use voltage transformers or plugs that deliver reduced amounts of electricity.
 - The AC adapter should be plugged into a nearby, easily accessible socket.
 - The AC adapter is for indoor use only.
 - When using the AC adapter with devices such as power strips, only use Class II devices that are approved for use in your country.
- Do not expose devices to fire, microwaves, direct sunlight, high or extremely low temperatures.
- Do not let devices come into contact with liquid and do not use them with wet or oily hands. Do not use or store in humid locations. If liquid gets inside, stop using and contact Nintendo Customer Support.
- Do not expose devices to excessive force. Do not pull on cables and do not twist them too tightly.
- Do not touch device connectors with your fingers or metal objects.
- Do not touch the AC adapter or connected devices during a thunderstorm.
- Use only compatible accessories that have been approved for use in your country.
- If you hear a strange noise, see smoke or smell something strange, follow these steps, exercising caution while handling the console: unplug the AC adapter from the socket, disconnect the AC adapter and any accessories from the console, turn the console off and contact Nintendo Customer Support.
- Do not disassemble or try to repair devices.
 - If devices are damaged, stop using them and contact Nintendo Customer Support. Do not touch damaged areas. Avoid contact with any leaking fluid.

⚠ WARNING – General

- Keep this console, its accessories and packaging materials away from young children and pets. Small parts such as game cards, microSD Express memory cards and packaging items may be accidentally ingested.
- Keep this console and its accessories away from implanted medical devices. The console and its accessories (including Joy-Con 2 controllers and the Joy-Con 2 grip) contain magnets and/or use wireless communication. Do not use within 15cm of cardiac pacemakers or other implanted medical devices. Consult a doctor before use if you are using any type of medical device.
- Wireless communication may not be allowed in certain places such as aeroplanes or hospitals. Please follow respective regulations.
-  Do not use headphones to listen at high volume levels for long periods due to high sound pressure and hearing damage risk. Keep the volume at a level at which you can hear your surroundings. Consult a doctor if you experience symptoms such as buzzing in your ears.
- Persons who have an injury or disorder involving their fingers, hands or arms should not use the vibration feature.
- When plugging the AC adapter in, make sure that the cable does not cause a tripping hazard.

CAREFUL USAGE

- Please note that the operating temperature for this product is between 5°C and 35°C.
- Do not place the console in humid areas or areas where the temperature can suddenly change. If condensation forms, turn the power off and wait until the water droplets have evaporated.
- Do not use in dusty or smoky areas.
- Do not cover the air intakes or vents on the console (pictured) or the dock to avoid overheating. If dust or another foreign substance builds up on the air intakes or vents, remove it using a vacuum.
- Do not place anything on top of the AC adapter cable.
- Pay attention to the load capacity of the circuit when choosing where to plug the product in.
- When the AC adapter will not be in use for longer periods of time, remove it from the socket to prevent damage due to overvoltage.
- If the AC adapter becomes dirty, unplug it and wipe it with a soft, dry cloth. If the console or an accessory becomes dirty, turn the power off and disconnect any cables as applicable, then wipe it with a soft, slightly damp cloth. Avoid using thinner or other solvents. After cleaning, make sure products are completely dry before using them again.
- Be aware of your surroundings while playing.
- Make sure to charge the built-in batteries at least once every six months. If the batteries are not used for an extended period of time, it may become impossible to charge them.
- The screen is covered with a film layer designed to prevent fragments scattering in the event of damage. Do not peel it off.

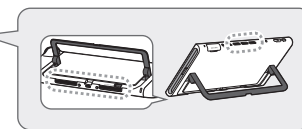

Using the Joy-Con 2 Controllers

Charge and pair controllers before using them for the first time. You can charge and pair controllers by attaching them directly to the console or using the Joy-Con 2 charging grip (BEE-010) (sold separately).

To charge the controllers fully when they are attached to the console, ensure that the console is charging at the same time.

- Observe the following precautions when using Joy-Con 2 controllers:

- To detach a Joy-Con 2 from the console, press the release button on the back of the Joy-Con 2 and pull gently outwards. To avoid dropping and damaging the console, only press the release button when holding both the console and controller securely.
- To avoid dropping and damaging the console, do not swing or dangle the console from an attached Joy-Con 2 or apply force to the connecting parts while playing.
- When playing with one or more Joy-Con 2 controllers detached from the console, attach a Joy-Con 2 strap to each controller when instructed to do so in the software. To attach a Joy-Con 2 strap accessory, match the + or - Button on the controller with the same symbol on the accessory. Secure the strap around your wrist and hold the controller firmly. You can detach a strap by holding the release button on the back of the Joy-Con 2 it's attached to.
- The Joy-Con 2 controllers attach to the console and the Joy-Con 2 grip using a magnetic connection. Do not affix stickers to the part of a Joy-Con 2 where the SL/SR Buttons are located. Doing so could weaken the connection and could cause the controller to detach unexpectedly.
- If small metal objects such as screws or tacks become affixed to the magnetic areas on the console or Joy-Con 2 grip, use a cotton swab to remove them. Do not touch them with your fingers. Continuing to use the product without removing such objects could result in damage to the Joy-Con 2 controllers or could cause them to detach unexpectedly.

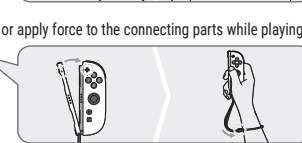

- Observe the following precautions when using mouse controls:

- If any dust or dirt is present on the Joy-Con 2, the Joy-Con 2 strap or the table or surface being used, wipe it clean before use.
- Use the Joy-Con 2 on a flat surface with no sharp edges or protrusions.
- Avoid using the Joy-Con 2 on surfaces that are easily scratched. It is recommended that you use a mousepad or mat.
- Do not strike the Joy-Con 2 forcefully or press on it when moving it around.

Please make sure you read the Health and Safety Information page on the Nintendo Switch™ 2 console once it has been set up. You can access this information from SUPPORT in  (System Settings) on the HOME Menu.

IMPORTANT INFORMATION FOR PARENTS

Parental Controls

Nintendo Switch 2 offers a variety of exciting features. However, as a parent, you might want to restrict certain things which you deem unsuitable for children. We have prepared special steps to enable you to make Nintendo Switch 2 safe for your family.

Nintendo Switch 2 Parental Controls are available on the console itself and can also be controlled by an app on your smart device. During the initial setup of your console, you can select how you would like to set Parental Controls. Follow the on-screen instructions to finish setting Parental Controls.

On the console itself, you can use a PIN to set and change your desired Parental Controls settings. Your PIN can also be used to temporarily disable Parental Controls if you should wish to do so.

You can also change your settings at any time – even when you are away from home – using the dedicated app.

Purchase Restrictions in Nintendo eShop

In order to restrict Nintendo eShop purchases, you must associate your child's Nintendo Account with your Nintendo Account. Access your Nintendo Account on a smart device or PC to create an account for your child or associate an existing account with yours and set restrictions as you deem appropriate in the Nintendo Account settings.

<https://accounts.nintendo.com>









How to Activate Sleep Mode or Turn Off the Console

Press the POWER Button to enter or exit sleep mode.

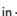
Hold the POWER Button for at least 12 seconds to turn off the console.

How to Activate and Deactivate Wireless Network Ports

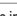
This product has two available wireless network ports, Wi-Fi* (internet) and Bluetooth®.

Play modes	 TV mode	 Tabletop mode	 Handheld mode
Wi-Fi	Active / OFF	Active / OFF	Active / OFF
Activating Wi-Fi	Go to Internet in  (System Settings) on the HOME Menu and proceed to set up a connection.		
Deactivating Wi-Fi	Start  (System Settings) from the HOME Menu in handheld mode, then set Flight Mode to On with Wi-Fi set to Off.		
Play modes	 TV mode	 Tabletop mode	 Handheld mode
Bluetooth	Always Active**	Active / OFF	Active / OFF
Activating Bluetooth		Go to Flight Mode in  (System Settings) on the HOME Menu and proceed to set Flight Mode to Off. Or, with the flight mode function still enabled, set Bluetooth to On.	
Deactivating Bluetooth		Start  (System Settings) from the HOME Menu, then set Flight Mode to On with Bluetooth set to Off.	

* Please note that the Wi-Fi network port will be functional only after the relevant network update is applied.

** The Bluetooth network port in TV mode is always active, because the console will always be reactivated using a controller paired with Bluetooth.

Disposal of this Product

Do not dispose of this product or built-in batteries in household waste. For details see <https://www.nintendo.com/eu/docs>

The batteries should be removed by a qualified professional. Visit <https://www.nintendo.com/eu/battery> for more information.

Warranty

Warranty UK and Ireland

[240925/UKV-HW-BEE]

24-MONTH MANUFACTURER'S WARRANTY – NINTENDO SWITCH™ 2

This warranty covers Nintendo Switch 2 consoles (the "Nintendo console") including the original built-in software included with the respective Nintendo console at the time of purchase (the "Nintendo Operating Software") and any controllers included within the console packaging (the "Nintendo Controllers"). In this warranty, the Nintendo console, the Nintendo Operating Software and the Nintendo Controllers are referred to together as the "Product".

Subject to the terms and exclusions below, Nintendo of Europe SE, Goldsteinstrasse 235, 60528 Frankfurt, Germany ("Nintendo") warrants to the original consumer purchasing the Product in the United Kingdom, any country of the European Economic Area (excluding Spain and Portugal) or Switzerland ("you") that, for a period of 24 months from the date of the purchase of the Product by you, the Product will be free from defects in materials and workmanship.

EXCLUSIONS

This warranty does not cover:

- software (other than the Nintendo Operating Software) or games (whether included with the Product at the time of purchase or not);
- accessories, peripherals or other items that are intended for use with the Product but are not manufactured by or for Nintendo (whether included with the Product at the time of purchase or not);
- the Product if it has been resold, or used for rental or commercial purposes;
- defects in the Product that are caused by accidental damage, your and/or any third party's negligence, unreasonable use, modification, use with products not supplied, licensed or authorised for use with the Product by Nintendo (including, but not limited to, non-licensed game enhancements, copier devices, adapters, power supplies or non-licensed accessories), computer viruses or connecting to the internet or other forms of electronic communication, use of the Product otherwise than in accordance with the respective instructions, or any other cause unrelated to defects in material and workmanship;
- defects in the Product that are caused by the use of faulty, damaged or leaking batteries or battery packs, or any other use of batteries or battery packs not in accordance with the respective instructions;
- gradual decrease over time in the capacity and performance of batteries and battery packs for the Product (which, for the avoidance of doubt, will not be deemed to be a defect in material or workmanship of the Product);
- the Product if it has been opened, modified or repaired by any person or company other than Nintendo or its authorised partners, or if the Product has its serial number altered, defaced or removed;
- loss of any data that has been loaded onto or stored on the Product by any person or company other than Nintendo or its authorised partners;
- loss of data or any other content, such as software, as a result of formatting the memory of the Product (or the microSD Express memory card or any other external storage device being used with the Product); or
- loss of data or any other content as a result of deleting a Nintendo Account registered or linked to the Product.

HOW TO MAKE A CLAIM

To make a valid claim under this warranty, you must:

- notify Nintendo of the defect in the Product within 24 months of the date of the purchase of the Product by you, and
- return the Product to Nintendo within 30 days of notifying Nintendo of that defect.

To make a claim, please contact Nintendo Customer Support via support.nintendo.com

Before sending the Product to Nintendo Customer Support, you should remove or delete any private or confidential files or data.

By sending the Product to Nintendo you accept and agree that Nintendo will not be responsible for any loss, deletion or corruption of your files or data that has not been deleted or removed. Nintendo strongly recommends that you make a backup copy of any data that you do not remove or delete. Please note that, depending on the type of repair, data or other content stored in the memory of the Product may be deleted, and you may not be able to read data or other content saved to your microSD Express memory card or to any other external storage device, or import it back onto the Product following such repair.

When sending the Product to Nintendo Customer Support, please:

1. use the original packaging where possible;
2. provide a description of the defect;
3. attach a copy of your proof of purchase, which indicates the date of purchase of the Product.

If, having inspected the Product, Nintendo accepts that the Product is defective, Nintendo will (at its sole discretion) either repair or replace the part causing the defect, or replace the relevant element of the Product without charge.

If the above 24-month warranty period has expired at the time the defect is notified to Nintendo or if the defect is not covered by this warranty, Nintendo may still be prepared to repair or replace the part causing the defect or replace the relevant element of the Product (at its sole discretion). For further information or, in particular, details of any charges for such services, please contact Nintendo Customer Support via support.nintendo.com

This manufacturer's warranty does not affect any statutory rights which you may have under consumer protection legislation as the purchaser of goods. The benefits described here are in addition to those rights.

Technical Specifications

Nintendo Switch 2	Operating frequency band(s)	Maximum radio-frequency power
Bluetooth	2402-2480MHz	9dBm
Wi-Fi	2412-2472MHz	14dBm
	5180-5250MHz	11.5dBm
	5250-5320MHz (indoor use only)*	
	5500-5700MHz	

Joy-Con 2 (L)	Operating frequency band(s)	Maximum radio-frequency power
Bluetooth	2402-2480MHz	6.5dBm

Joy-Con 2 (R)	Operating frequency band(s)	Maximum radio-frequency power	Maximum field strength
Bluetooth	2402-2480MHz	6.5dBm	-
NFC	13.56MHz	-	-7.68dBµA/m

	* This restriction applies in the following countries: Austria (AT), Belgium (BE), Bulgaria (BG), Croatia (HR), Cyprus (CY), Czech Republic (CZ), Denmark (DK), Estonia (EE), Finland (FI), France (FR), Germany (DE), Greece (EL), Hungary (HU), Iceland (IS), Ireland (IE), Italy (IT), Latvia (LV), Liechtenstein (LI), Lithuania (LT), Luxembourg (LU), Malta (MT), Netherlands (NL), Norway (NO), Poland (PL), Portugal (PT), Romania (RO), Slovakia (SK), Slovenia (SI), Spain (ES), Sweden (SE), Switzerland (CH) and United Kingdom (Northern Ireland) (UK(NI)).

Ecodesign Information for the Nintendo Switch 2 AC Adapter	
Commercial registration number of EU authorised representative	HRB Nr. 135709
Model identifier	NGN-01(UK)
Input voltage	AC 100 – 240V
Input AC frequency	50/60Hz
Output (voltage/current/power)*	DC 5.0V / 3.0A / 15.0W DC 9.0V / 3.0A / 27.0W DC 15.0V / 3.0A / 45.0W DC 20.0V / 3.0A / 60.0W
Average active efficiency	81.4%
Efficiency at low load (10%)	76.9%
No-load power consumption	0.10W

* The AC adapter (NGN-01(UK)) has four types of DC output power, and the output voltage is automatically changed depending on the connected device.

Product Ecodesign Information: Information concerning this product's energy efficiency and resource efficiency is available at <https://www.nintendo.com/eu/ecodesign>
The power consumption of the product in network standby if all wired network ports are connected and all wireless network ports are activated is max 2.0W.

Warning concerning changing/deactivating the power management functions

Auto-Sleep: If you increase the time or select "Never", the console will consume more energy.

Maintain Wired Connection in Sleep Mode: If this option is enabled and the console uses a wired internet connection, downloads will start immediately even when the console is in sleep mode, but the console will consume more energy.

Power Requirements and EU Common Charger Information	
Nintendo Switch 2 (BEE-001)*	
	The power delivered by the charger must be between min 2.5 watts required by the radio equipment, and max 12 watts in order to achieve the maximum charging speed.

*TV mode requires output power of 54 watts. This is higher than the power requirements for charging given above. This product supports USB PD fast charging and is capable of being recharged by means of wired charging at voltages up to 15 volts.

For explanation of the symbols and markings used on this product, see <https://www.nintendo.com/eu/docs>

DECLARATION OF CONFORMITY

Hereby, Nintendo declares that the radio equipment type (Nintendo Switch 2/Joy-Con 2) is in compliance with Directive 2014/53/EU. The full text of the EU declaration of conformity is available at the following internet address: <https://www.nintendo.com/eu/docs>

For UK: Hereby, Nintendo declares that the radio equipment type (Nintendo Switch 2/Joy-Con 2) is in compliance with the relevant statutory requirements. The full text of the declaration of conformity is available at the following internet address: <https://www.nintendo.com/eu/docs>

Statement of Compliance – Applicable to products sold in the UK only.

Pursuant to section 9(2) of the UK Product Security and Telecommunications Infrastructure Act 2022, Nintendo declares that its in-scope products meet the applicable security requirements for manufacturers set out in Schedule 1 of the UK Product Security and Telecommunications Infrastructure (Security Requirements for Relevant Connectable Products) Regulations 2023. Please see Nintendo's full Statement of Compliance at <https://www.nintendo.com/en-gb/Legal-information/Product-Security-2474043.html>

The Bluetooth® word mark and logos are registered trademarks owned by Bluetooth SIG, Inc. and any use of such marks by Nintendo is under license. Other trademarks and trade names are those of their respective owners.

© Nintendo
Nintendo Switch is a trademark of Nintendo.

Support Information

For more information about Nintendo Switch 2, please visit the Nintendo Support website.



<https://support.nintendo.com>



Manufacturer: Nintendo Co., Ltd., Kyoto 601-8501, Japan

EU authorised representative & importer:

Nintendo of Europe SE, Goldsteinstrasse 235, 60528 Frankfurt, Germany

UK economic operator: Nintendo UK, Quadrant, 55-57 High Street, Windsor SL4 1LP, UK

MXAS-BEE-S-U5G-WWW1